

WP-30113-P132

SHT 1.1

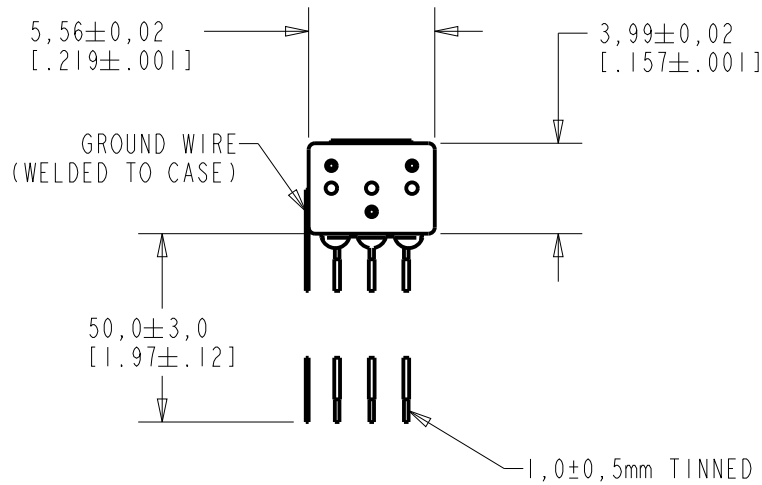

NOTE:

1. INCREASED PRESSURE AT THE SOUND INLET CAUSES A POSITIVE GOING VOLTAGE TO APPEAR AT THE OUTPUT TERMINAL, RELATIVE TO THE NEGATIVE TERMINAL.
2. WIRE GAGE AND PLATING OF LEAD WIRE: 36AWG, SILVER PLATED.
3. SOLDER COMPOSITION: 96.5Sn3Ag0.5Cu

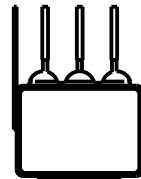
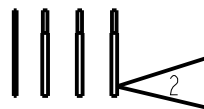
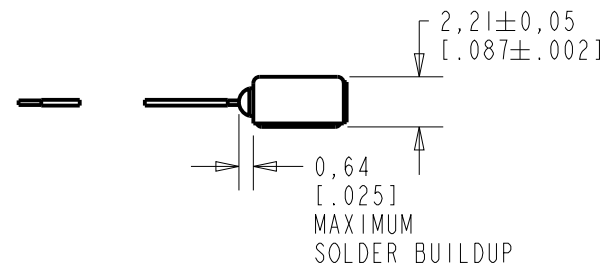
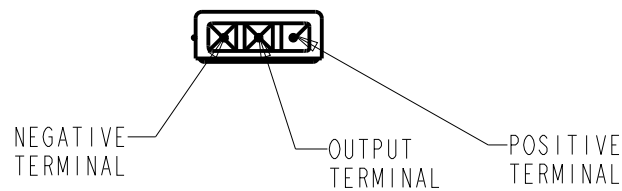

DIMENSIONS IN MILLIMETERS [INCHES]

WIRE COLOR			
POSITIVE	OUTPUT	NEGATIVE	GROUND
RED	GREEN	BLACK	NICKEL WIRE

Revision	C.O. #	Implementation Date	RELEASE LEVEL	REVISION
B	PI0002318	6-21-18	Active	B
A	PI0001951	5-16-18		

SCALE: 3:1		DR. BY	DATE
DO NOT SCALE DRAWING		DVJ	5-16-18
TITLE: MICROPHONE & CABLE		CK. BY	DATE
WP-30113-P132		GJP	5-16-18
OUTLINE DRAWING		APP. BY	DATE
SHT 1.1		GJP	5-16-18

KNOWLES CORPORATION

SENSITIVITY IN dB RELATIVE TO 1.0 VOLT/0.1 Pa (N/M²)
FOR CONDITIONS SHOWN BELOW.

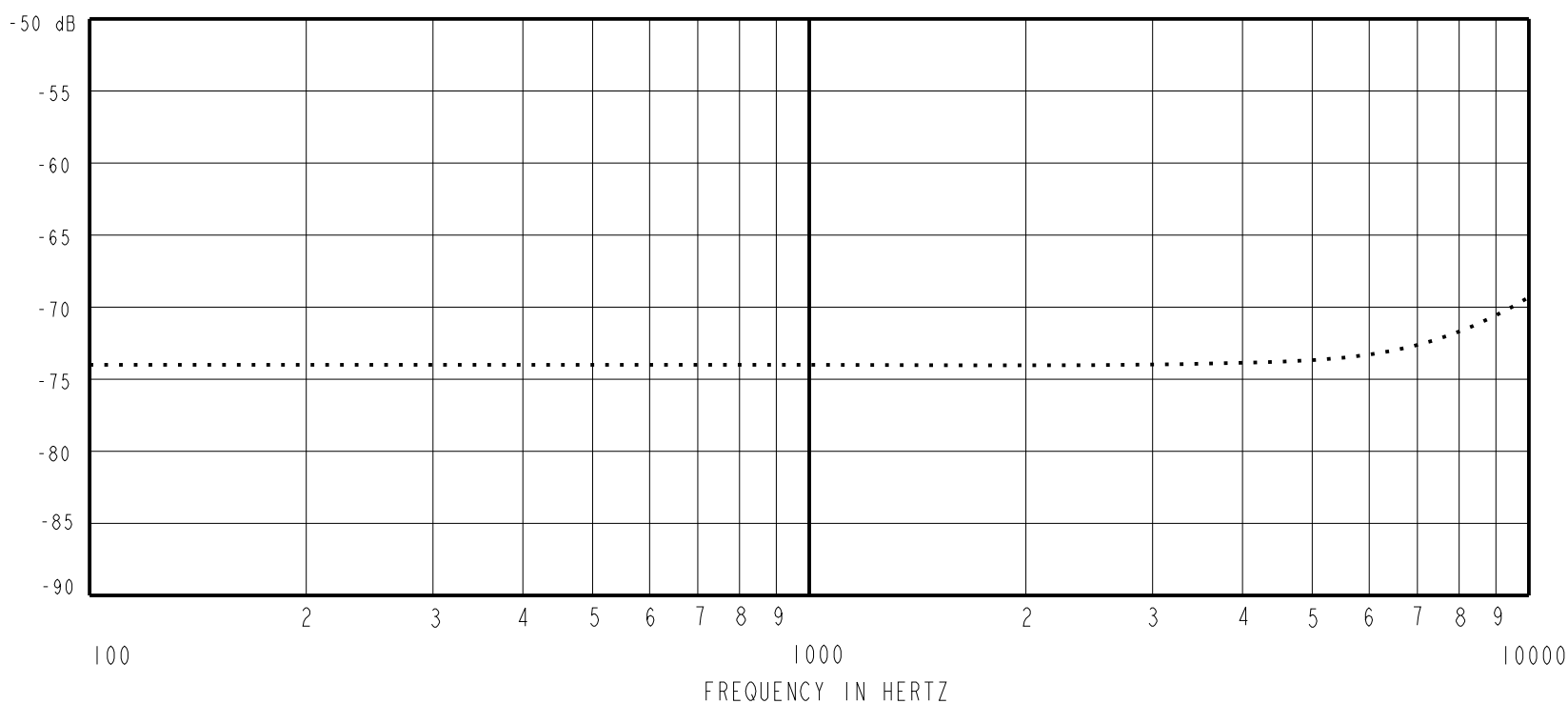

FREQUENCY	SENSITIVITY			DEVICE CONFORMITY	
	MIN.	NOM.	MAX.	RANGE OF DEVIATION FROM 1KHz	
100	---	-74.0	---	-4.0	+4.0
1000	-78.0	-74.0	-70.0	0.0	0.0
10000	---	-69.0	---	+1.0	+9.0

NOTES:

1. ALL TEST DATA TAKEN WITH TEST CIRCUIT SHOWN BELOW.
2. CASE CONNECTED TO NEGATIVE TERMINAL USING EXTERNAL JUMPER WIRE.
3. MICROPHONE TO BE FUNCTIONAL WITH 10 VDC SUPPLY.
4. SOUND PORT SEALED TO APERTURE OF B&K TYPE 4227 MOUTH SIMULATOR.
5. FOR MICROPHONE CAPSULE SPEC. SEE WP-30113-000 SHEET 2.1
6. CONFORMS TO REQUIREMENTS SHOWN 'ELECTRET MICROPHONE ENVIRONMENTAL QUALIFICATIONS TEST, EK-PA SHEET 2.2' WITH REF.FREQUENCY OF 1000HZ.
7. TYPICAL SENSITIVITY TO HUMIDITY AT 1000 HZ IS 0.02dB/%RH.
8. SENSITIVITY AND NOISE VALUES INDICATED ON THIS SPECIFICATION ARE VALID AT 50% HUMIDITY.

PORT LOCATION	DC SUPPLY	AMPLIFIER CURRENT DRAIN	SENSITIVITY CHANGE ON REDUCING SUPPLY TO 0.9VDC	"A" WEIGHTED NOISE (1 kHz EQUIV. SPL)
KA	1.3V	50uA MAX.	4.0 dB MAX.	40.0 dB MAX.

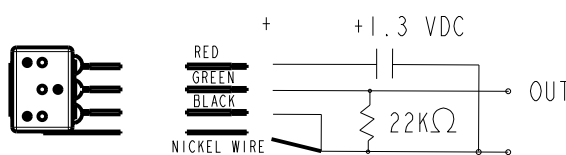

TEST CIRCUIT

Revision	C.O. #	Implementation Date	RELEASE LEVEL	REVISION
B	PI0002318	6-21-18	Active	B
A	PI0001951	5-16-18		

KNOWLES CORPORATION

WHEN TEST LIMITS ARE USED TO ESTABLISH INCOMING INSPECTION ACCEPTANCE/REJECTION CRITERIA, CORRELATION OF TEST EQUIPMENT WITH KNOWLES IS ALSO REQUIRED FOR ELIMINATION OF EQUIPMENT AND TEST METHOD VARIATION

TITLE: **MICROPHONE & CABLE**
PERFORMANCE SPECIFICATION

WP-30113-P132
SHT 2.1

DR. BY	DATE
DVJ	5-16-18
CK. BY	DATE
GJP	5-16-18
APP. BY	DATE
GJP	5-16-18